



Type woning : Villa

Zwembad : Ja

Opp. woning :

152 m²

Locatie : Las Colinas Golf

Opp. terrein :

562 m²

Slaapkamers : 3

Badkamers : 2



ORQUIDEA COMMUNITY
Villa Verderón



■ Covered Sun Deck
■ Winter Sun Deck
■ Pooling Plot

PLOT	PLOT SURFACE m ²	MAXIMUM BUILDABLE m ²	BEDROOMS	BATHROOMS	BASEMENT / GARAGE
3	667,71	152,50	3	2+1	2 plots
4	668,13	152,50	3	2+1	2 plots
5	662,36	152,50	3	2+1	2 plots

Excluded brands: SCHÜCO, DURAVIT, SIEMENS
 Certificación energética / Eficiencia energética

EXAMPLE OF DISTRIBUTION
Villa Verderón



Room	m ²
Ground floor	4782
01 Living room / Dining room	4782
02 Hallway	5,30
03 Bedroom 1	16,76
04 Bedroom 2	14,80
05 WC	1,68
06 Bath	4,61
07 Pool Terrace	2,71
08 Swimming pool	26,75

Plot 3
 Plot surface: 667 m²
 Maximum buildable: 152.50 m²

EXAMPLE OF DISTRIBUTION
Villa Verderón



Room	m ²
First floor	370
09 Hallway	3,93
10 Bedroom 2	13,26
11 Bedroom 3	13,26
12 Bedroom 1	5,33
13 Terrace 1	35,76

EXAMPLE OF DISTRIBUTION
Villa Verderón

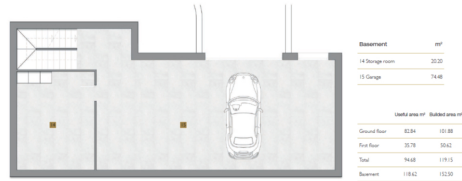

Room	m ²
Basement	74,68
14 Storage room	30,20
15 Garage	74,68

Level area m ²	Buildable area m ²
Ground floor	62,84
First floor	35,78
Total	144,68
Basement	119,42
	152,50



PARCELA / PLOT 3
 SUPERFICIE (m²) / SURFACE (sq.m) **667**
 EDIFICABILIDAD (m²) / BUILDABILITY (sq.m) **152.50**



GROUND FLOOR PLAN - PLOT 3



Comunidad
ORQUIDEA
 Community